

FITTING INSTRUCTIONS

EUL RANGE LEVER ON ROSE

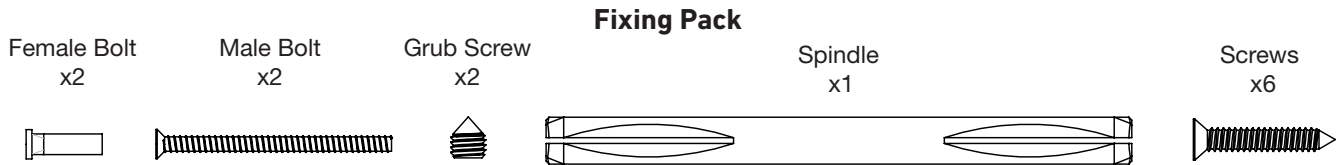

1. Mark out centre hole **A** depending on the backset of your lock/latch. Using a 20mm diameter bit, drill centre hole **A** through the door as marked out in step 1.

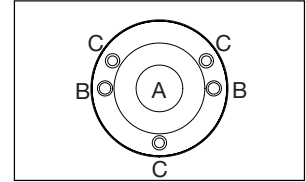

2. Insert the spindle into the lever and securely fix the grub screw, ensure enough spindle is free to pass through the door and to be secured in the opposing lever.

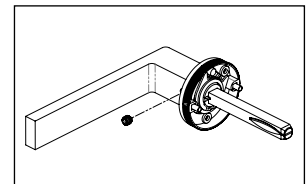

3. Offer the lever up to the door so the spindle passes through centre hole **A** for the latch/lock and mark the fixing holes **B & C**.

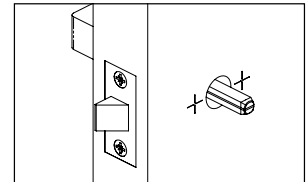

4. Offer the second lever up to the opposite side of the door and use the marking method outlined in step 3.

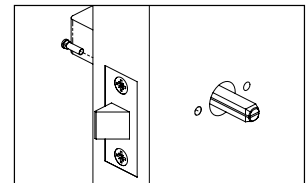

5. Remove the lever from the door, using a 5mm diameter bit drill fixing holes **B**. Using a 2mm drill bit, drill pilot holes to a depth of 5mm for fixing holes **C**.

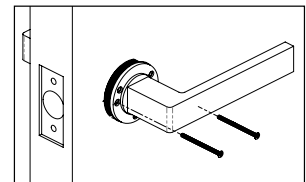

6. Offer the lever up to the door so the spindle passes through centre hole **A** for the latch/lock and female fixings pass through fixing holes **B**.

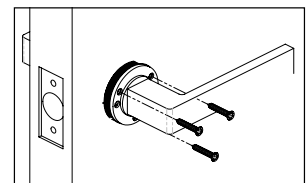

7. Offer the second lever up to the opposite side of the door and insert male fixings through fixing holes **B**. Using a screwdriver, tighten each of the male bolts so each lever is secured firmly against the surface of the door.

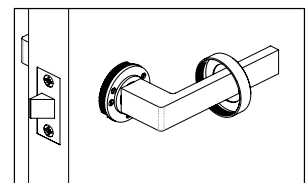

8. Using a screwdriver and screws provided secure lever in place using predrilled pilot holes in fixing holes **C**.

9. Once secured to the door tighten the remaining grub screw and recheck all fixings are secure. If the levers do not operate freely, check alignment of all components.

10. Carefully guide the outer rose covers over the levers and screw firmly onto the rose.

Maintenance

Ensure all fixings, including grub screws are secure, tighten where necessary. Clean with a soft lint free cloth.